

# Worm gear

<b>Properties:</b>	General:	Single-stage worm gear For use in combination with our motors.
	Housing:	Aluminium
	Output:	Power deviation 90° Self locking on higher gear reduction ( $\eta < 50\%$ )
		Lifetime grease lubrication
	Options:	Special shaft, 2nd shaft end

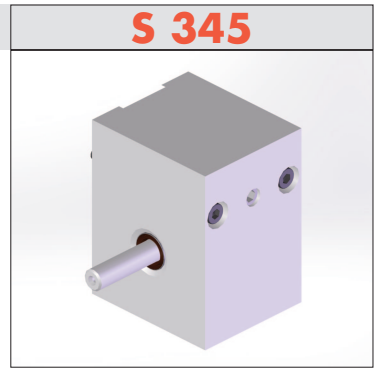

<b>Loading capacity</b>	Max. radial force	N	100
	Max. axial force	N	50
	Max. input speed	rpm	4500
	Temperature range	°C	-20° – +40°
<b>Mounting</b>	Shaft diameter	mm	6
	Weight	kg	1.2
	Mounting type (standard)		Flange

<b>Gear ratios</b>	<b>i</b>	<b>M (Nm)</b>	<b><math>\eta</math></b>
	5	1.8	0.65
	10	1.9	0.60
	15	1.9	0.50
	25	1.8	0.40
	30	1.9	0.35
	40	1.4	0.20
	50	2.0	0.30
	60	1.6	0.25

## Dimensions

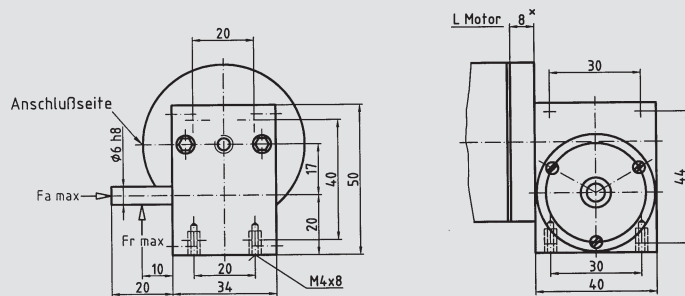

<sup>x</sup> Entfällt für Baugröße 3

